

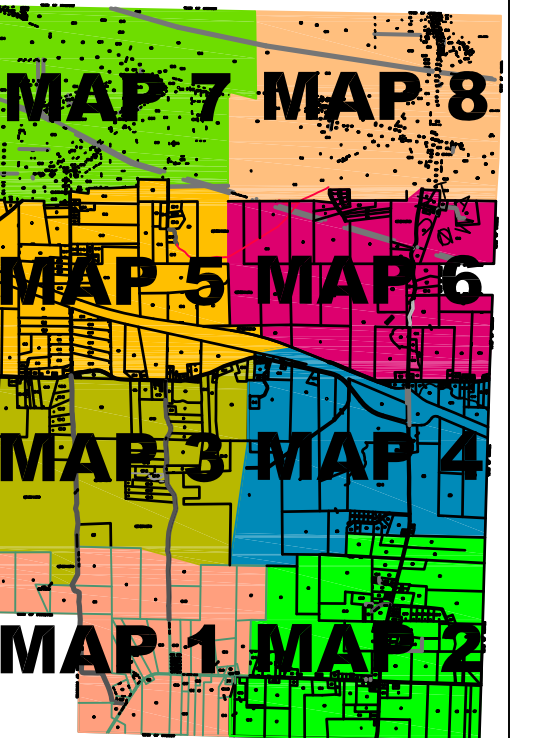

FOR TAX ASSESSMENT PURPOSES NOT TO BE USED FOR CONVEYANCES

OCTOBER 2014



REVISION HISTORY	
DATE	DESCRIPTION
JUNE 17, 2022	

DIGITAL CONVERSION AND REVISIONS BY

PERRY LAND SURVEYING
SINCE 1979

ALAN R. PERRY PLS 2194
20 SHORE LANE ETNA ME 04434
(207) 269-2971 (207) 942-6909
email - alan@perrylandsurveying.com

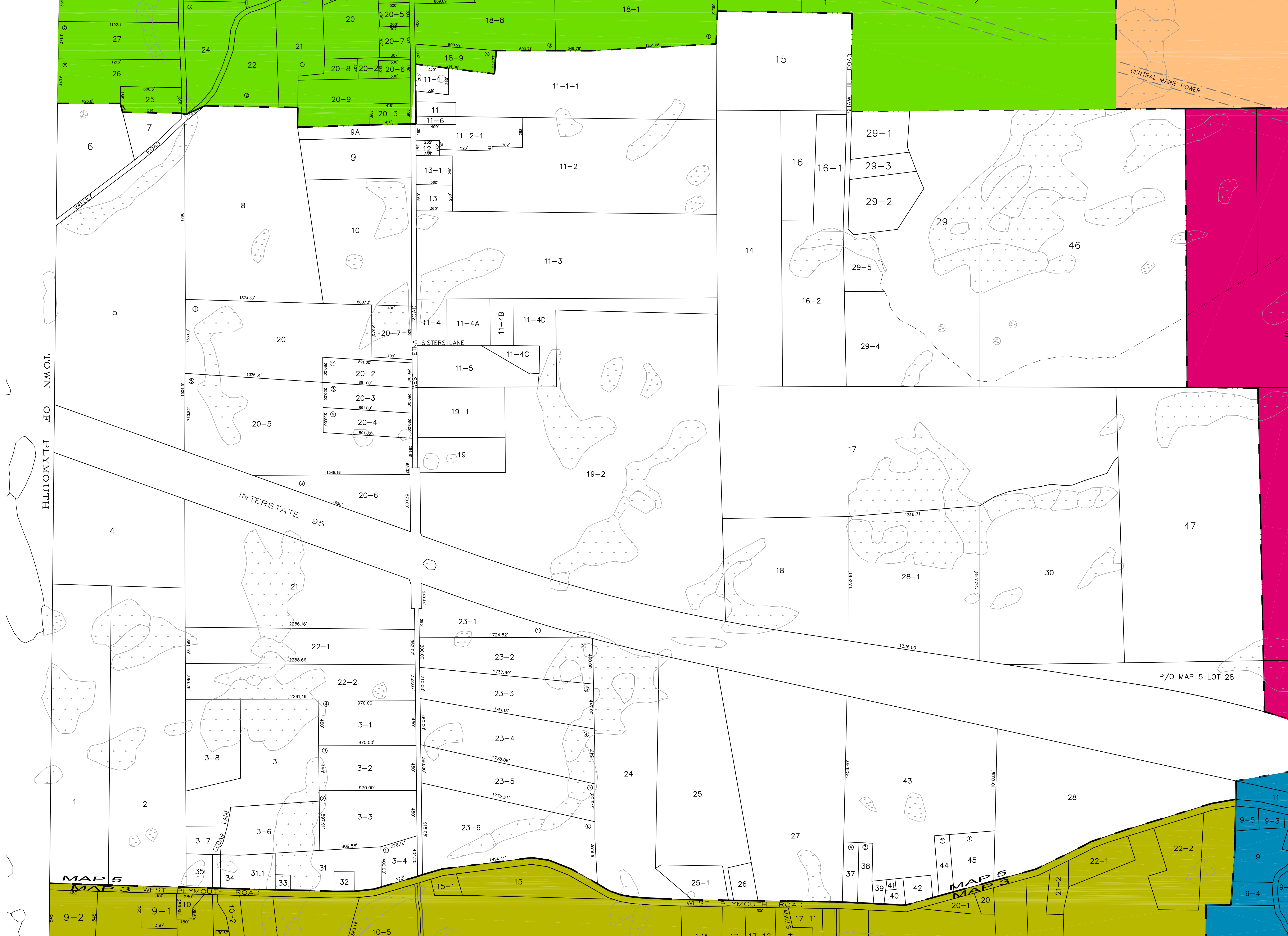
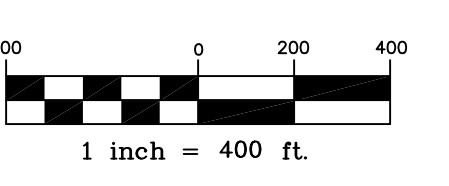

TOWN OF PLYMOUTH

P/O MAP 5 LOT 28

MAP 5
MAP 3

MAP 5
MAP 3